

DRS24C Series

15V Power Supply Replacement

Section 7.0

Replacing your 15V power supply

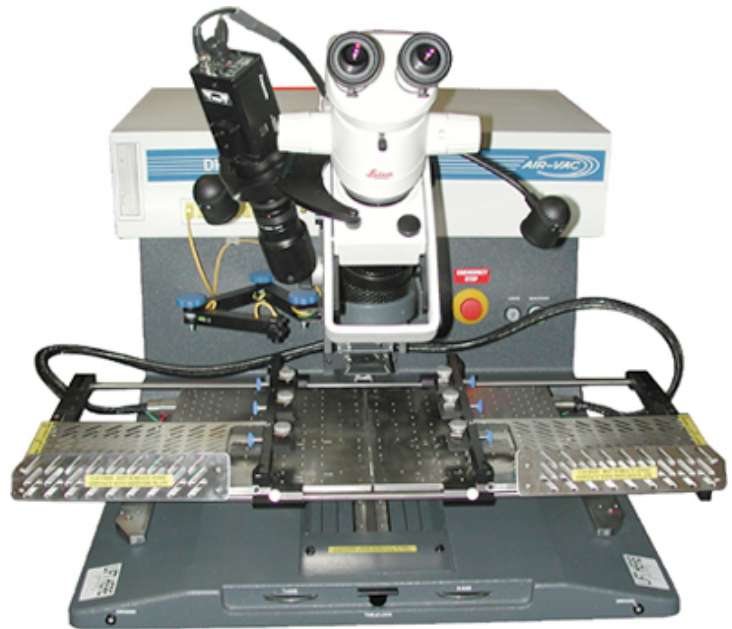

BEFORE YOU START:

Read instructions thoroughly before beginning.



ELECTRICAL WARNING:

POWER DOWN DRS24 AND DISCONNECT FROM POWER SOURCE.



CAUTION:

OBSERVE PROPER STATIC PRECAUTIONS.



CHECKLIST:

The following items will be needed in this section.

- M4 Allen wrench
- 1/16" Allen wrench
- Slotted screw driver
- Black magic marker fine point
- 15V Power supply part no. 9002.10.010

For technical problems, please contact the Air-Vac technical service department at:

Air-Vac Engineering Company, Inc.

30 Progress Avenue • Seymour, CT 06483

Phone: 203-888-9900 • Fax: 203-888-1145

e-mail: solder.tech@air-vac-eng.com • www.air-vac-eng.com • 03/26/01

7.0 15V Power Supply Replacement

! IMPORTANT

VERIFY DRS24 IS DISCONNECTED FROM THE POWER SOURCE.

NOTE

The 15V power supply is part of the power module assembly, located in the right side of the DRS module (A), (fig.1).

✓ STEPS:

- 1** Remove the 10/32" button head screw (B), (fig.1), and swing right box open.

Fig. 1

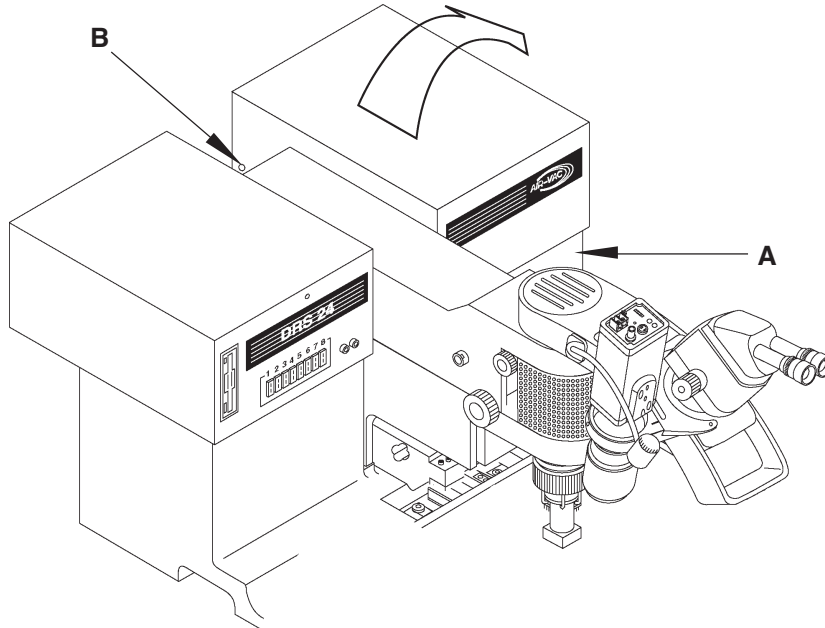

- 2** Disconnect J1-AC power connector and J2-DC power connector. Mark thermocouple plugs as follows:
 - wire #126 - mark a #1 on both the plug and jack.
 - wire #127 - mark a #2 on both the plug and jack.
 - wire #128 - mark a #3 on both the plug and jack.
- 3** Disconnect all plugs and connectors and lay these wires neatly on top of panel. This will help avoid any interference of cables hanging up once panel is removed from machine. Close box.

- 4 From bottom of DRS24, remove the four M4 screws that hold the power module assembly in.

CAUTION

USE EXTREME CAUTION WHEN REMOVING SCREWS.

- 5 Once the screws from step 4 are removed, slide the DRS24 off the bench in the direction of the X & Y thumb wheels. Slide the DRS only until the 2 forward feet slide off of the bench.

NOTE

You will see and hear when the feet have come far enough forward. Use caution and do not slide forward fast. Be gentle to avoid damage to the DRS and yourself.

- 6 Open right box and move behind the DRS24.

NOTE

The remaining steps will be performed assuming you are located behind the DRS24.

- 7 Gently slide the power module assembly (C), (fig.2), out of the DRS24. As the power module starts to come out, allow the power and thermocouple connectors to fall in front of the module.

IMPORTANT

DO NOT FORCE THE MODULE OUT. IF IT APPEARS TO BE STUCK, CHECK TO SEE WHAT WIRES ARE BEING CAUGHT. REMEMBER, THERE ARE WIRES ON BOTH SIDES OF THE POWER MODULE AND SOME TIMES THEY HAVE TO BE MOVED A LITTLE BIT TO ALLOW THE REMOVAL OF THE PANEL.

Fig. 2

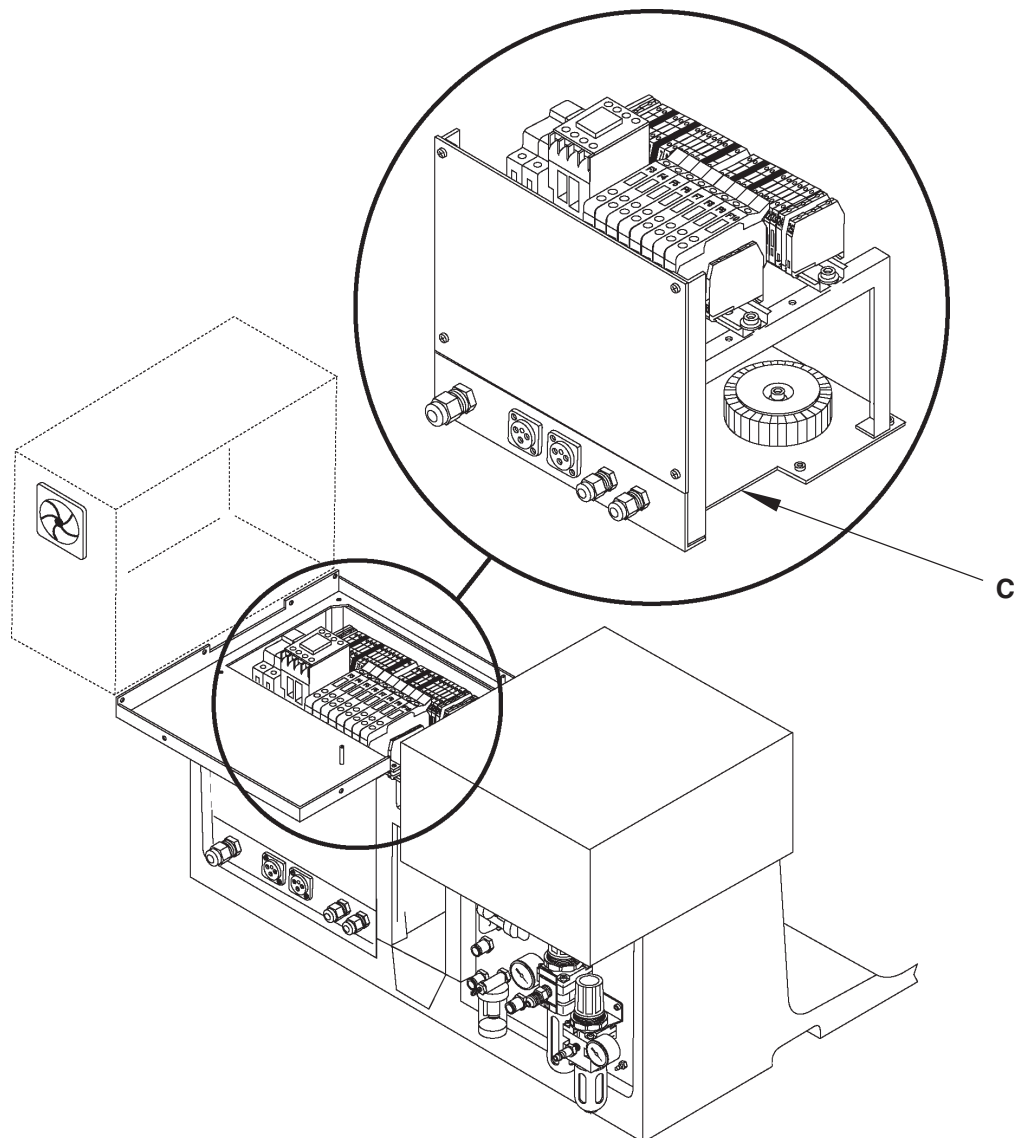

- 8 Remove the 2 allen screws (D) (fig.3), that hold the 15V power supply (E) to the power module assembly (F).
- 9 The 15V power supply will now come out. Remove the power supply toward the front of the DRS24. The wires are long enough to allow the power supply to come out and be replaced.
- 10 Refer to figure 4 for the correct wiring.

NOTE

Make sure the proper wire# is on the correct pin of the power supply.

- 11 Reverse steps for installation of power supply.

Fig. 3

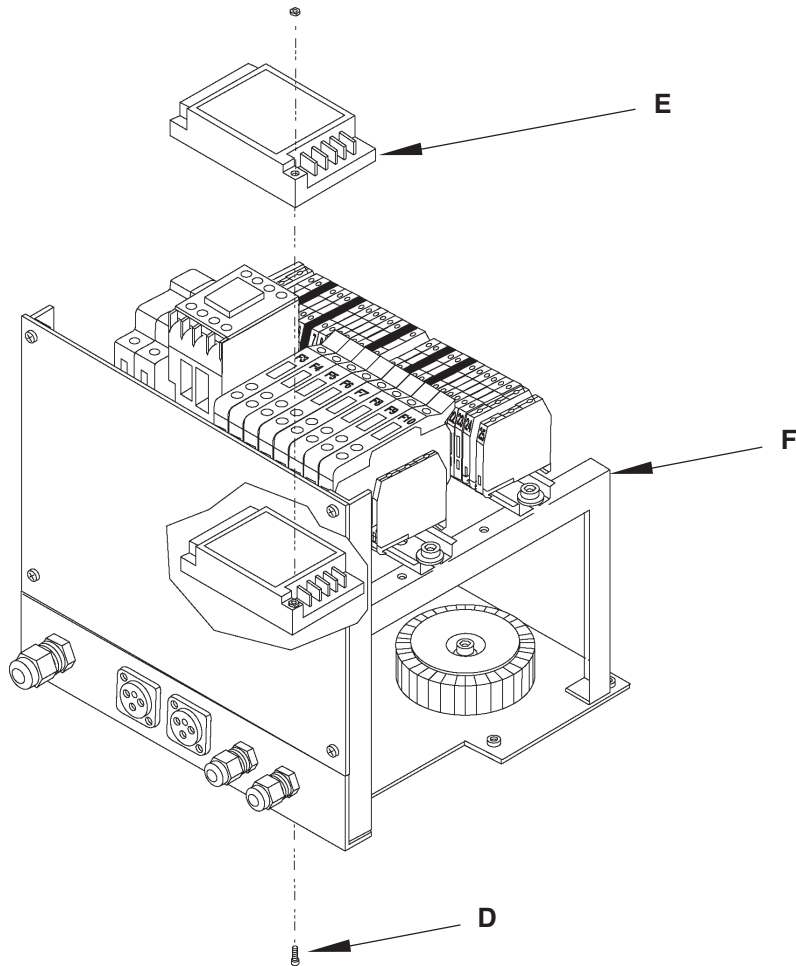

MASS FLOW POWER SUPPLY

Fig. 4

